



Flowmeters for oxygen-therapy for rail mounting

IDENTIFICATION

- ▶ Flowmeters for oxygen and medical air supply
- ▶ Chrome-plated brass body
- ▶ Supplied in single or double version
- ▶ To be completed with male probe available in most diffused international standards
- ▶ Support for rail mounting or wall mounting on wall slide
- ▶ Filter positioned at the tube inlet for patient and flow meter protection
- ▶ Adjustment of gas flow by means of hand-knob
- ▶ Instant reading of the distributed flow rate by means of the graduated scale on the tube (expanded scale for 0 l/min to 5 l/m)
- ▶ Laser-engraved production lot and product code on the flow meter body
- ▶ Flexible hose standard ISO 5359 standard length L=1,5 m



CE MARKING

Flow meters:

Notified body 0426

CE marking in risk class II A in accordance with Legislative Decree 24 February 1997, no. 46 "Implementation of Directive 93/42/EEC, concerning Medical Devices" and further modifications

Probes:

Refer to the "Terminal Units" datasheet, "Outlet probes for terminal units" section

REFERENCE STANDARDS

ISO 15002: "Flow-metering devices for connection to terminal units of medical gas pipeline systems"

ISO 15001: "Anaesthetic and respiratory equipment. Compatibility with oxygen"

HTM 02-01: "Medical gas pipeline systems"

*Validity of the standards is referred to the current year



- ▶ Gases: Oxygen, Air, CO₂
- ▶ Measurement scale: 0 ÷ 15 l/min
- ▶ Measurement precision: ± 10%
- ▶ Maximum flow rate: 20 l/min
- ▶ Pressure source limits:
P_{min} = 400 kPa; P_{max} = 500 kPa
- ▶ Working temperature: +10 °C ÷ +40 °C
- ▶ Storage temperature: -20 °C ÷ +60 °C

- ▶ Humidifier connection fitting: 1/4" autoclavable humidifier; 9/16" disposable humidifier
- ▶ Resolution: 0.5 l/min between 0 and 6 l/min
- ▶ Resolution: 1 l/min between 6 l/min and 15 l/min
- ▶ Sintered inlet filter with 24 µm mesh
- ▶ Single flowmeter code **PF-2670-yyyy**
Packaging, dimensions: box, 18.5 x 16.5 x 5.5 cm
- ▶ Double flowmeter code **PF-2650-yyyy**
Packaging, dimensions: box, 21 x 19 x 17.5 cm





Flowmeters for oxygen-therapy for rail mounting

DIMENSIONS

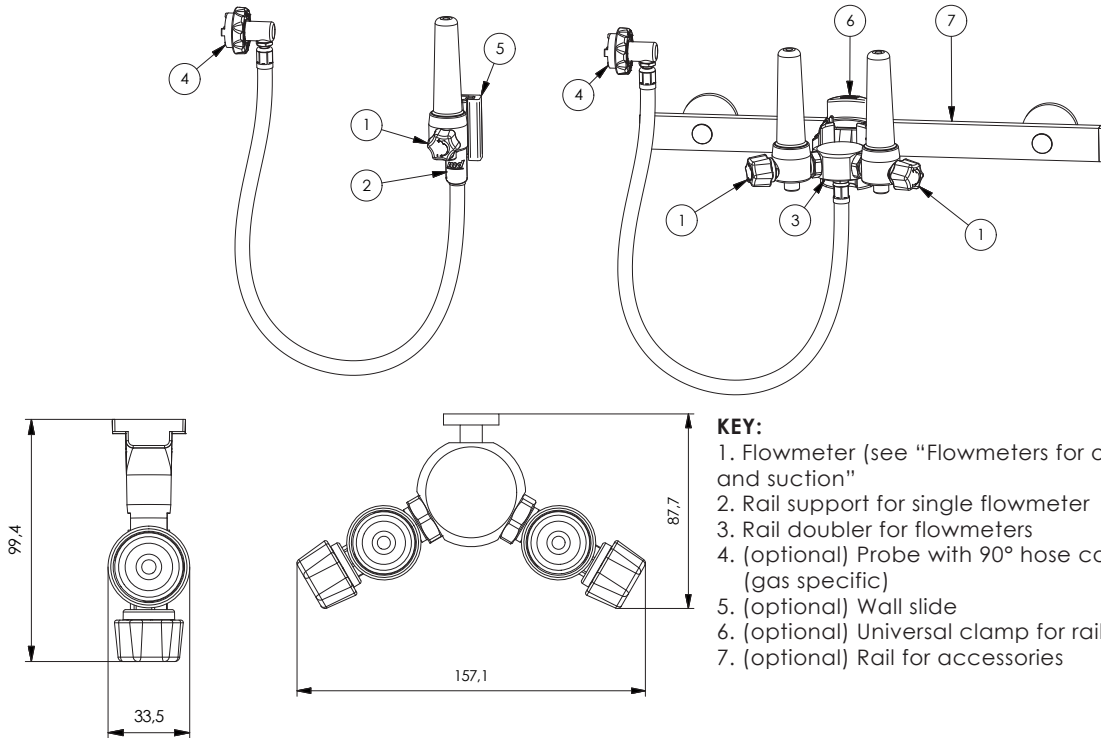

- KEY:**
1. Flowmeter (see "Flowmeters for oxygen-therapy and suction")
 2. Rail support for single flowmeter
 3. Rail doubler for flowmeters
 4. (optional) Probe with 90° hose connector (gas specific)
 5. (optional) Wall slide
 6. (optional) Universal clamp for rail
 7. (optional) Rail for accessories

FLOWMETER

TYPE	GAS	CODE	OUTLET	PACKAGING		
				type	kg	pcs
Single flowmeter for rail	Oxygen	PF-2670-14O2 PF-2670-96O2	G 1/4" 9/16"	box	0.21	1
	Medical Air	PF-2670-14AC PF-2670-96AC	G 1/4" 9/16"	box	0.21	1
	Carbon Dioxide	PF-2670-14CO PF-2670-96CO	G 1/4" 9/16"	box	0.21	1
Double flowmeter for rail	Oxygen	PF-2650-14O2 PF-2650-96O2	G 1/4" 9/16"	box	0.51	1
	Medical Air	PF-2650-14AC PF-2650-96AC	G 1/4" 9/16"	box	0.51	1
	Carbon Dioxide	PF-2650-14CO	G 1/4"	box	0.51	1
		PF-2650-96CO	9/16"	box		

PROBE WITH HOSE CONNECTOR 90° (OPTIONAL)

GAS	CODES / REFERENCE STANDARD			
	AFNOR NF S 90-116	UNI 9507	DIN 13260-2	BS 5682
Oxygen	PF-06AP-00O2	PF-06UP-00O2	PF-06DP-00O2	PF-06BP-00O2
Medical Air	PF-06AP-00AC	PF-06UP-00AC	PF-06DP-00AC	PF-06BP-00AC
Carbon Dioxide	PF-06AP-0CO2	PF-06UP-0CO2	PF-06DP-0CO2	-

FASTENING SYSTEM FOR ACCESSORIES (OPTIONAL)

CODE	DESCRIPTION	PACKAGING	
		type	kg
PF-2900-6000	Universal rail clamp 25-35 mm	bag	0.09
PF-2900-5000	Wall slide	bag	0.09

