



## High pressure second-stage flow regulators



### IDENTIFICATION

- ▶ Second stage pressure regulator for the reduction and stabilisation of pressure;
- ▶ Inlet and outlet pressure gauges;
- ▶ Pipes inlet and outlet with fitting for pipe welding;
- ▶ Sintered inlet filter to protect downstream line;
- ▶ Laser engraved marking of production lot and product code;
- ▶ Screw pressure adjustment for exit gas flow;
- ▶ Provision for safety valve;

### CE MARKING

Notified body: 0426

CE marking in risk class II B in accordance with Legislative Decree 24 February 1997, no. 46 "Implementation of Directive 93/42/EEC, concerning Medical Devices" and further modifications

### REFERENCE STANDARD

**ISO 10524-2:** "Pressure regulators for use with medical gases - Part 2: Manifold and line pressure regulators"

**ISO 7396-1:** "Medical gas pipeline systems - Part 1: Pipeline systems for compressed medical gases and vacuum"

**ISO 15001:** "Anaesthetic and respiratory equipment. Compatibility with oxygen"

\* Validity of the standards is referred to the current year

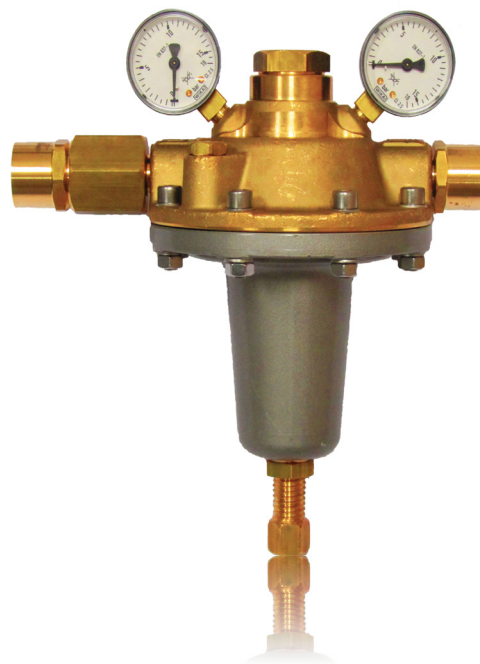

- ▶ Gases: Oxygen, Medical Air
- ▶ Storage temperature: -20 °C ÷ +60 °C
- ▶ Working temperature: -10 °C ÷ +40 °C
- ▶ Inlet/outlet pipe diameter: Ø = 22 x 1 mm
- ▶ Inlet degree of filtration ≤ 90 µm

- ▶ Provision for pressure sensor connection G 1/4" F
- ▶ Inlet pressure gauge scale: 0 ÷ 16 bar
- ▶ Outlet pressure gauge scale: 0 ÷ 10 bar
- ▶ Inlet/outlet pressure gauges accuracy class: 2.5
- ▶ Maximum flow rate: 120 m<sup>3</sup>/h\*

\* See Pressure Flow / Characteristics graph





# High pressure second-stage flow regulators

## DIMENSIONS

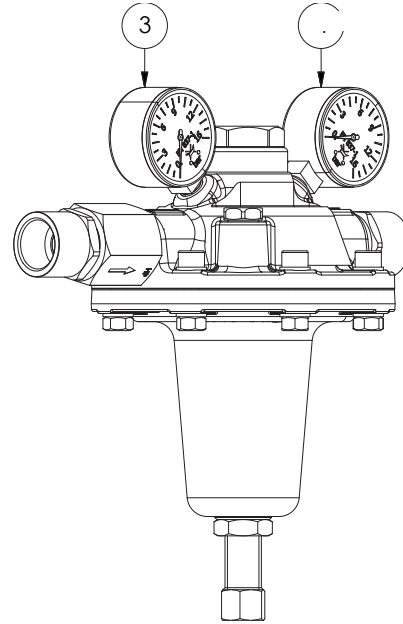
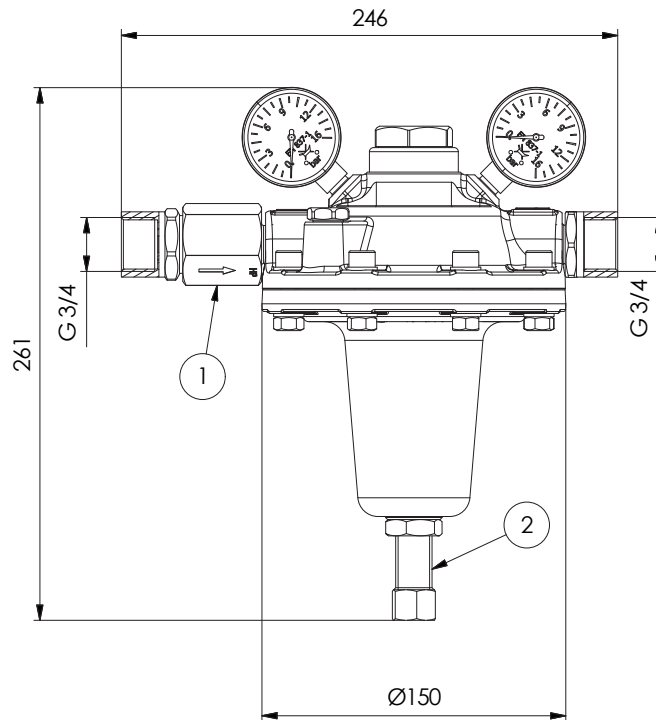
**KEY:**

- 1. Inlet G 3/4" F
- 2. Outlet G 3/4" F
- 3. Pressure regulation screw
- 4. 0-16 bar inlet pressure gauge
- 5. Outlet pressure gauge

PRESSURE/FLOW CHARACTERISTIC, INLET PRESSURE 8 BAR

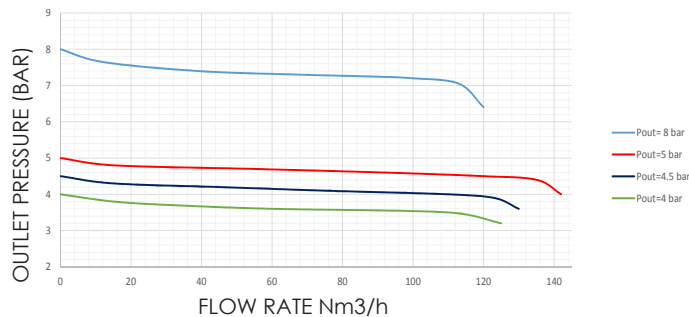

GAS	CODES	INLET/OUTLET CONNECTION	NOMINAL OUTLET PRESSURE bar	PACKAGING		
				type	cm	kg
O <sub>2</sub>	PF-5500-A0O2	G 3/4" F	4 ÷ 10	box	40X60X30	5.5
Medical Air	PF-5500-A0AC	G 3/4" F	4 ÷ 10	box	40X60X30	5.5
O <sub>2</sub>	PF-5500-00O2	pipe welding fitting Ø 14	4 ÷ 10	box	40X60X30	5.5
Medical Air	PF-5500-00AC	pipe welding fitting Ø 22	4 ÷ 10	box	40X60X30	5.5





## Pressure stabilisation panel

### IDENTIFICATION

- ▶ Double line for stabilisation;
- ▶ Possibility to shut-off and isolate one line thanks to the valves;
- ▶ Provision for sensors for pressure in/out;
- ▶ Provision for safety valves;
- ▶ Inlet/outlet pressure gauge for each regulation line;
- ▶ Optional cover for external installation;



### CE MARKING

Notified body: 0426  
CE marking in risk class II B in accordance with  
Legislative Decree 24 February 1997, no. 46  
"Implementation of Directive 93/42/EEC, concerning  
Medical Devices" and further modifications

### REFERENCE STANDARD

**ISO 10524-2:** "Pressure regulators for use with medical gases - Part 2: Manifold and line pressure regulators"

**ISO 7396-1:** "Medical gas pipeline systems - Part 1: Pipeline systems for compressed medical gases and vacuum"

**ISO 15001:** "Anaesthetic and respiratory equipment. Compatibility with oxygen"

\* Validity of the standards is referred to the current year

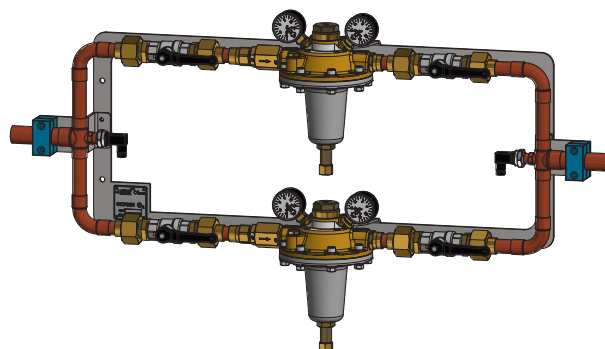

- ▶ Gas: Oxygen, Medical Air
- ▶ Storage temperature: -20 °C ÷ +60 °C
- ▶ Working temperature: -10 °C ÷ +40 °C
- ▶ Inlet/outlet pipe diameter: Ø = 28 x 1,5 mm
- ▶ Inlet degree of filtration ≤ 90 µm

- ▶ Provision for pressure gauge connection: G 1/4"
- ▶ Inlet pressure gauge scale: 0 ÷ 16 bar
- ▶ Outlet pressure gauge scale: 0 ÷ 10 bar
- ▶ Inlet/outlet pressure gauges accuracy class: 2.5
- ▶ Possibility to shut-off and isolate one line in case of maintenance
- ▶ Maximum flow rate: 120 m<sup>3</sup>/h\*

\* See Pressure Flow / Characteristics graph 55xx technical sheet





# Pressure stabilisation panel

## DIMENSIONS

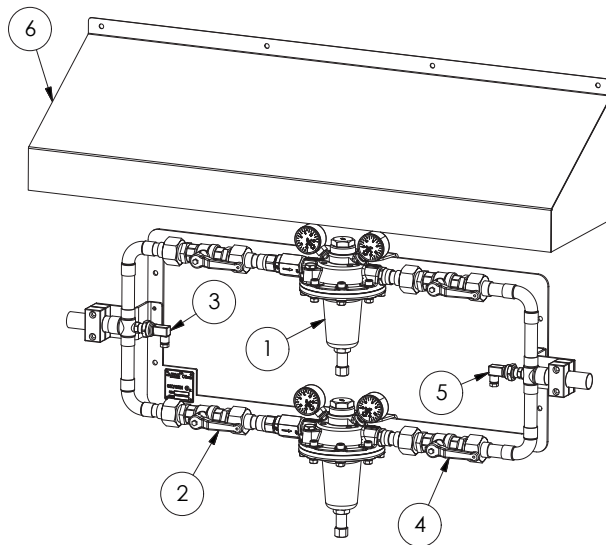
**KEY:**

1. High-pressure second stage flow regulator
2. Inlet G3/4"
3. 0-16 bar inlet transducer (optional)
4. Outlet G3/4"
5. 0-16 bar outlet transducer (optional)
6. Stainless steel cover (optional)

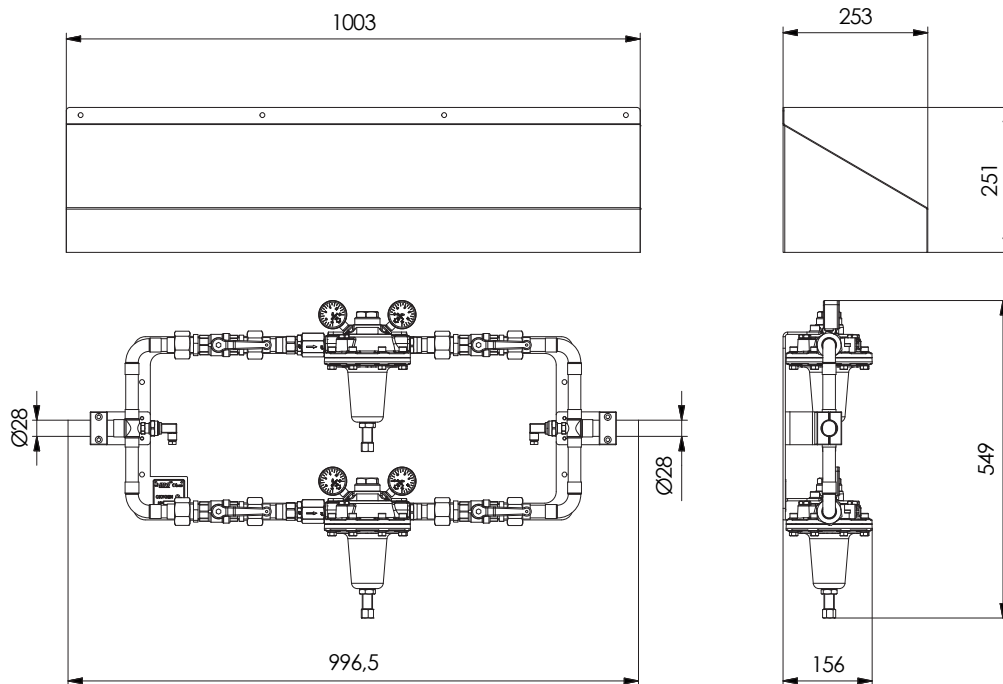

## PRESSURE STABILISATION PANEL

CODES	GAS	INLET/OUTLET	OUTLET NOMINAL PRESSURE bar	PACKAGING		
				type	cm	kg
PF-442B-B628	O <sub>2</sub>	Ø 28	4 ÷ 10	pallet	80x120x35	14.3
PF-442B-B128	Medical Air	Ø 28	4 ÷ 10	pallet	80x120x35	14.3

## COVER

CODES	MATERIAL	PACKAGING		
		type	cm	kg
PF-442B-B60T	Stainless steel	pallet	80x120x40	8.2

